

## Braukmann MiniPlus FF06/FF06-AAM

Installation instructions

Istruzioni di montaggio

Instrucțiunile de montaj

Einbauanleitung

Installatievoorschrift

Monteringsvejledningen

Instructions d'installation

Beépítési útmutató

Instrukcja montażu

Instrucciones de instalación

Руководство по установке

Instruksjoner for installasjon



Fine Filter

Feinfilter

Filtre fin

Filtro fino

Filtro a maglia fine

Fijnfilter

Finomszűrő

Фильтр тонкой очистки

Filtru fin

Fint filter

Filtr dokładny

Finfilter

## 1 Safety Guidelines

- Follow the installation instructions.
- Use the appliance
  - according to its intended use
  - in good condition
  - with due regard to safety and risk of danger.
- Note that the appliance is exclusively for use in the applications detailed in these installation instructions (see 2 Technical Data). Any other use will not be considered to comply with requirements and would invalidate the warranty.
- Please take note that any assembly, commissioning, servicing and adjustment work may only be carried out by authorized persons.
- Immediately rectify any malfunctions which may influence safety.

## 2 Technical Data

### 2.1 FF06

<b>Media</b>	
Medium:	Drinking water
<b>Connections/Sizes</b>	
Connection sizes:	1/2" - 1 1/4"
<b>Pressure values</b>	
Max. operating pressure:	16 bar
<b>Operating temperatures</b>	
Max. operating temperature medium accord. to EN 1567:	30 °C
<b>Specifications</b>	
Installation position:	Horizontal with filter bowl downwards

Note: The filter is constructed for drinking water installations. In case of a process water application the filter has to be proven individually.

### 2.2 FF06-AAM

<b>Media</b>	
Medium:	Drinking water
<b>Connections/Sizes</b>	
Connection sizes:	1/2" - 1 1/4"
<b>Pressure values</b>	
Max. operating pressure:	25 bar
<b>Operating temperatures</b>	
Max. operating temperature medium:	70 °C
<b>Specifications</b>	
Installation position:	Horizontal with filter bowl downwards

Note: The filter is constructed for drinking water installations. In case of a process water application the filter has to be proven individually.

## 3 Options

For Options visit [homecomfort.resideo.com/europe](http://homecomfort.resideo.com/europe)

## 4 Assembly

### 4.1 Installation Guidelines

- Install in horizontal pipework with filter bowl downwards
  - This position ensures optimum filter efficiency
- Install shut-off valves
- These filters are armatures which need to be maintained regularly
- Ensure good access
  - Degree of contamination can be easily seen with clear filter bowl
  - Simplifies maintenance and inspection
- The installation location should be protected against frost
- Related to the EN 806-2 it is recommended to install the filter immediately after the water meter
- In order to avoid flooding, it is recommended to arrange a permanent, professionally dimensioned wastewater connection

### 4.2 Assembly instructions



We recommend to install an inlet check valve



#### CAUTION!

Observe the flow direction when mounting the backflow preventer.



#### CAUTION!

When connecting the solder sockets, do not solder the sockets together with the filter. High temperatures destroy internal parts which are important to the function!

- Thoroughly flush pipework
- Install filter
  - Note flow direction
  - Install without tension or bending stresses

### 4.3 Drain for rinse water

**i** The rinse water must be piped to the drain in such a way that no back pressure can occur

1. Discharge into drain connector
2. Discharge into floor drain

Filter size	Reverse rinsing quantity*	C (mm)
1/2" - 1 1/4"	25 litres	20

\*at 4 bar inlet pressure and a rinse duration of 15 seconds

## 5 Maintenance

**i** In order to comply with EN 806-5, water fixtures must be inspected and serviced on an annual basis. As all maintenance work must be carried out by an installation company, it is recommended that a servicing contract should be taken out.

In accordance with EN 806-5, the following measures must be taken:

### 5.1 Inspection

- Non-compliance can lead to the filter becoming blocked. This results in a drop in pressure and decreased water flow.
  - The filter meshes are made of stainless steel. A red coating as a consequence of rust from the pipelines has no influence on function or the way the filter works.
1. Close shut-off valve on inlet and outlet
  2. Release pressure on outlet side (e.g. through water tap)

**i** If rinse water goes into a container, a suitable container must first be placed below it.

## 7 Troubleshooting

Problem	Cause	Remedy
Too little or no water pressure	Shut-off valves upstream or downstream from filter not fully open	Open the shut-off valves fully
	Filter mesh dirty	Clean or replace filter
	Not fitted in flow direction	Fit filter in flow direction

## 8 Spare Parts

For Spare Parts visit [homecomfort.resideo.com/europe](http://homecomfort.resideo.com/europe)

## 9 Accessories

For Accessories visit [homecomfort.resideo.com/europe](http://homecomfort.resideo.com/europe)

3. Use the wrench to disassemble the filter bowl.
4. Replace filter mesh and supporting body in filter insert
5. Reassemble in reverse order

## 5.2 Maintenance

**i** If necessary, the outside surface of the filter combination can be cleaned. Use only cold, clear drinking water to clean the surfaces! Any other cleansers cause damage to the plastic components!

### 5.2.1 Replace filter mesh

1. Close shut-off valve on inlet
2. Release pressure on outlet side (e.g. through water tap)
3. Close shut-off valve on outlet
4. Unscrew filter bowl
  - Use double ring wrench ZR06F
5. Remove filter cartridge
6. Dismount filter insert
7. Replace filter mesh
8. Clean sieve
9. Clean filter bowl
10. Mount the filter insert
11. Re-insert the filter insert
12. Put O-ring on filter bowl
13. Screw in filter bowl hand-tight (without tools)
14. Slowly open shut-off valve on inlet
15. Slowly open shut-off valve on outlet

## 6 Disposal

Observe the local requirements regarding correct waste recycling/disposal!

4.2

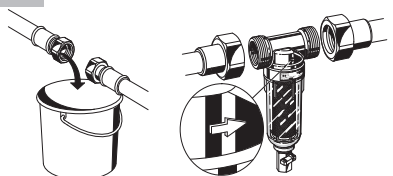

4.3

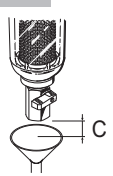

5.1

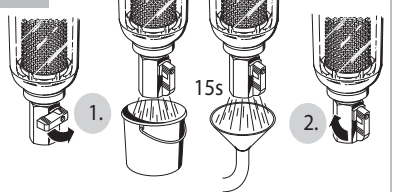

5.2.1

