



GBS-Series

POWERFUL MODELS IN A FLEXIBLE RANGE OF SIZES



GBS-Series

Heat Exchangers of the GBS-Series are the solid all-rounders among all brazed plate heat exchangers from Kelvion. The latest technology and decades of experience of successful applications guarantee highest quality, cost efficiency and reliability. Equipped with the proven technical features like Safety Chamber™, Delta Injection™ and Full Flow System™ the units are ideal for applications of all sizes with max. 200°C/392°F and up to 40 bar/580 psi.

The product range also offers the widest variety and flexibility in terms of sizes, different connections, flow arrangements and accessories. Thus heat exchangers of the GBS-series always serve the right solution for your operating conditions.

Always a suitable solution at hand

The brazed plate heat exchangers from Kelvion offer tailor-made solutions for the widest range of application. We configure the most economically favorable model for you from the wide range of available sizes and the numerous optional features. We adapt this with individually positioned connections to meet your specific requirements.

Example:

- heating water and industrial water systems
- underfloor heating
- subcoolers and condensers
- economizer
- refrigerant evaporators
- oil coolers

Your advantages at a glance:

- highest flexibility
- compact design
- wide range of applications
- solid construction

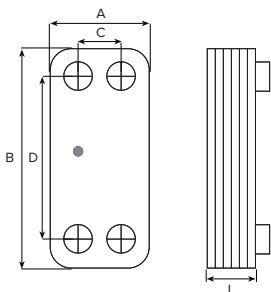

We need following information to select your optimum heat exchanger

- required temperature range
- flow rates or required heat load
- maximal permitted pressure drop
- required working conditions

| Type | (bar) | Standard dimensions (mm) | | | | (mm) | (kg) | (Litres/Channel) | |
|---|----------|--------------------------|-----|-----|-----|-------------------------------------|------------------------------|------------------|-----------------------|
| Plate heat exchanger | Pressure | A | B | C | D | L-Dimension N = number of plates | Mass N = number of plates | Volume | Max. number of plates |
| GBS 100M | 31 | 74 | 204 | 40 | 170 | 8.00+2.23xN | 0.70+0.050xN | 0.025 | 50 |
| GBS 200H | 31 | 90 | 231 | 43 | 182 | 10.00+2.24xN | 1.10+0.060xN | 0.030 | 50 |
| GBS 220H | 31 | 90 | 328 | 43 | 279 | 10.00+2.22xN | 1.30+0.080xN | 0.046 | 50 |
| GBS 240H | 31 | 91 | 464 | 43 | 415 | 10.00+2.20xN | 2.04+0.140xN | 0.070 | 50 |
| GBS 300H | 31 | 124 | 173 | 73 | 120 | 10.00+2.22xN | 1.20+0.060xN | 0.030 | 50 |
| GBS 400H | 31 | 124 | 335 | 73 | 281 | 9.50+2.24xN | 1.60+0.130xN | 0.065 | 100 |
| GBS 418L/M | 40 | 127 | 282 | 84 | 239 | 9.00+2.05xN | 1.35+0.118xN | 0.055 | 50 |
| GBS 420L | 31 | 127 | 282 | 68 | 223 | 9.00+2.76xN | 1.35+0.118xN | 0.076 | 150 |
| GBS 500H | 31 | 124 | 532 | 73 | 478 | 9.50+2.23xN | 1.76+0.210xN | 0.100 | 100 |
| GBS 525L/M/H | 36/34 | 118 | 525 | 69 | 476 | 9.00+2.58xN | 2.55+0.210xN | 0.125 | 100 |
| GBS 700L/M | 31 | 271 | 532 | 200 | 460 | 11.00+2.25xN | 9.60+0.540xN | 0.230 | 150 |
| GBS 757L/M/H | 35 | 281 | 543 | 198 | 460 | 11.50+2.65xN | 13.20+0.500xN | 0.310 | 160 |
| GBS 760L | 27/20 | 257 | 519 | 138 | 416 | 13.50+3.45xN | 12.60+0.400xN | 0.410 | 150 |
| GBS 800H | 31 | 271 | 532 | 161 | 421 | 11.50+2.34xN | 10.00+0.540xN | 0.221 | 260 |
| GBS 900H | 31 | 271 | 802 | 161 | 690 | 11.30+2.31xN | 11.50+0.800xN | 0.399 | 260 |
| GBS 910M | 36/32 | 318 | 783 | 225 | 690 | 14.00+2.54xN | 20.00+0.853xN | 0.480 | 200 |
| GBS 1000M/H | 31 | 386 | 875 | 237 | 723 | 20.30+2.31xN | 39.50+1.250xN | 0.600 | 360 |
| GBS 1000L | 31/16 | 386 | 875 | 237 | 723 | 22.65+2.35xN | 39.50+1.250xN | 0.466/0.733 | 360 |
| Also available as an advanced evaporator with a special „Delta Injection™“ distribution system for the refrigerant inlet. | | | | | | | | | |
| GBS 400H-AE | 31 | 124 | 335 | 73 | 281 | 9.50+2.24xN | 1.60+0.130xN | 0.065 | 100 |
| GBS 500H-AE | 31 | 124 | 532 | 73 | 478 | 9.50+2.23xN | 1.76+0.210xN | 0.100 | 100 |
| GBS 700M-AE | 31 | 271 | 532 | 200 | 460 | 11.00+2.25xN | 9.60+0.540xN | 0.230 | 150 |
| GBS 800H-AE | 31 | 271 | 532 | 161 | 421 | 11.50+2.34xN | 10.00+0.540xN | 0.221 | 260 |
| GBS 900H-AE | 31 | 271 | 802 | 161 | 690 | 11.30+2.31xN | 11.50+0.800xN | 0.399 | 260 |
| GBS 1000H-AE | 31 | 386 | 875 | 237 | 723 | 20.30+2.31xN | 39.50+1.250xN | 0.600 | 360 |

GBS-Series: Specifications

- plate material: Stainless steel AISI 316L / 1.4404
- brazing material: Copper

Features

- Safety Chamber™ (model 700, 757, 800, 900, 1000)
- Delta Injection™ (model 400, 500, 700M, 800, 900, 1000H)
- Full Flow System™ (model 100, 200, 220, 240, 300, 400, 500)

Performance limits

- working temperature: -196°C to +200°C / -321°F to +392°F
- working pressure: up to 40 bar / 580psi

Approval

- PED (CE), ASME VIII-1, UL

The specifications contained in this brochure are intended only to serve the non-binding description of our products and services and are not subject to guarantee. Binding specifications, especially pertaining to performance data and suitability for specific operating purposes, are dependent upon the individual circumstances at the operation location and can, therefore, only be made in terms of precise requests.

Kelvion Brazed PHE GmbH
 Remsaer Straße 2a, 04603 Nobitz-Wilchwitz, Germany
 Phone +49 34 47 55 39-0
 Fax +49 34 47 55 39-30
 sales.nobitz@kelvion.com
 www.kelvion.com

Kelvion PHE GmbH
 Karl-Schiller-Straße 1-3, 31157 Sarstedt, Germany
 Phone +49 50 66 601-0
 Fax +49 50 66 601-134
 sarstedt@kelvion.com

