

STC110



PART NUMBER

Part Number	Model Number	NL		WEIGHT	
		M	FT.	G	LB.
5123210000	STC110-200	2	6.5	100	0.22
5123212000	STC110-400	4	13.1	170	0.37

SPECIFICATIONS

Sensor element . . .NTC, 1.8 kohm at +25 °C (77 °F)

Operating temperature

Sensor element . . . -40 – +150 °C (-40 – +302 °F)

Cable -40 – +180 °C (-40 – +356 °F)

Time constant approx. 75 s

Enclosure rating (sensor). IP 54

Material

Sensor element steel

Cable silicon

Pipe Contact Temperature Sensor

STC110 is a temperature sensor designed for mounting on pipe systems of max. Ø 100 mm (4 in.).

The temperature sensor is supplied with a connection cable of 2 m or 4 m (6.5 or 13 ft.).

ACCURACY

At Temperature	Accuracy
-25 °C/-13 °F	±0.7 °C/±1.3 °F
0 °C/32 °F	±0.5 °C/±0.9 °F
25 °C/77 °F	±0.3 °C/±0.5 °F
50 °C/122 °F	±0.6 °C/±1.1 °F
75 °C/167 °F	±0.9 °C/±1.6 °F
100 °C/212 °F	±1.3 °C/±2.3 °F

DIMENSIONS mm (in)

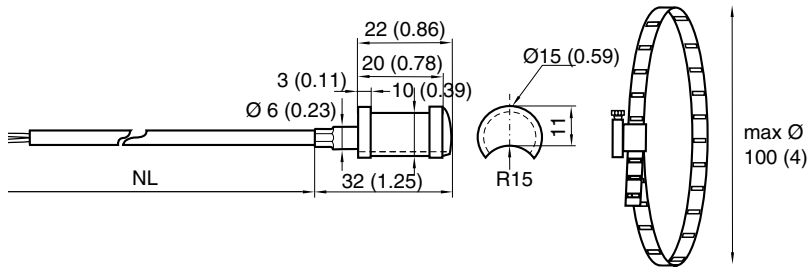

WIRING

